



Tree Doctors, Inc
 1415 W San Angelo St
 Gilbert AZ 85233-2408
 480-807-TREE
treedocs@treedoctorsinc.com

Proposal #66049
 Created: 03/04/2021
 Date: 06/24/2021
 From: Benjamin Fillmore

Proposal For

Warner Ranch IV Assoc

1414 W. Broadway Rd # 205
 Tempe, AZ 85282

main: 480-345-0046 X 55513
arathbun@sentrymgt.com

Location

6272 W Megan St
 Chandler, AZ 85226

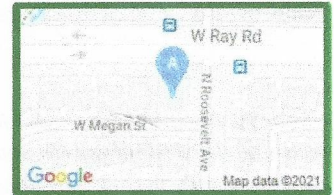

Terms

Due Upon Completion

ACCEPT	ITEM DESCRIPTION	AMOUNT
✓	Pruning Included Accepted MESQUITE PRUNING - crown clean, crown thin, crown raise, and crown reduce as needed for 72 Priority 1 Mesquite trees per TDI Tree Inventory.	\$ 14,805.00
✓	Pruning Included Accepted PRUNING - additional selected Priority 1 trees - crown clean, crown thin, crown raise, and crown reduce as needed per TDI Tree Inventory.	\$ 4,125.00
<input checked="" type="checkbox"/>	Pruning Optional Declined As your budget allows you should consider pruning 16 *2 olive trees.	\$ 1,510.04
✓	Removal Included Accepted Remove 4 trees.	\$ 275.00
✓	Stump Grinding - Level 1 Included Accepted Level 1 stump grind removes the stump to a depth of 4 to 6 inches below the ground. When grinding stumps, we will not be responsible for utility or irrigation lines which stumps have grown around or against. We leave holes backfilled with chips and over time these will decompose, settle. For an additional charge we can leave holes empty; for another additional charge we can backfill the holes with topsoil. Stump grinding does not guarantee that shoots will not propagate from the remaining roots. For an additional charge we do offer herbicide treatments to help prevent this from occurring. Please consult with your Tree Doctor's Arborist to find out if a herbicide application is appropriate for your species of tree being removed..	\$ 150.00
✓	Palms:Fan Palm Pruning Included Accepted Prune palm trees. Includes 1 foot of skinning.	\$ 1,200.00
✓	Env Fee (Trimming) 6% Included Accepted 6% Environmental Fee for disposal of tree trimmings	\$ 1,233.30



Tree Doctors, Inc
 1415 W San Angelo St
 Gilbert AZ 85233-2408
 480-807-TREE
 treecocs@treedoctorsinc.com

Proposal #66049
 Created: 03/04/2021
 Date: 06/24/2021
 From: Benjamin Fillmore

Please use the checkbox to mark items as accepted.

Meeting your expectations is very important to us. This estimate represents the recommended scope of work for your trees by your arborist. Please review it very carefully and discuss any questions and/or needed modifications with your arborist prior to approving and scheduling any work to be done. Any changes to the scope of work as outlined may require a new estimate and may be subject to additional charges that will need to be approved by you and your arborist.

SUBTOTAL	\$ 21,788.30
SALES TAX	\$ 21.55
TOTAL	\$ 21,809.85

Prices are guaranteed for 30 days from the date of this proposal.

Sales Tax: Calculated on 65% of Removal & Stump Grinding services only.

Signature

 Date: 4/20/21

Please sign here to accept the terms and conditions



WHERE TREE CARE IS A SCIENCE AND AN ART

Warner Ranch IV 2021

Management: Sentry Management

C/O: , Community Manager

Address:

Phone #

Fax #

Dated: February 2021 Prices valid for 30 days.

Submitted by: Benjamin Fillmore, ISA Certified Arborist for Tree Doctors, Inc

1415 W San Angelo St Gilbert, AZ 85233

Phone 480-844-4037 Fax 480-964-2412

Tree Inventory Map and Spreadsheet are proprietary and may not be duplicated or redistributed without written permission from Tree Doctors, Inc.

#	Species	Priority	Trimming	Removal	Stump Grinding	Fertilize	Comments
1	Acacia	2	\$ 160				
2	Mesquite	1	\$ 170				
3	Olive	*2	\$ 95				
4	Olive	*2	\$ 85				
5	Olive	*2	\$ 165				
6	Olive	*2	\$ 95				
7	Olive	*2	\$ 95				
8	Thevetia	3	\$ -				
9	Fan Palm						
10	Fan Palm						
11	Fan Palm						
12	Bird of Paradise	3	\$ -				
13	Bird of Paradise	3	\$ -				
14	Fan Palm						
15	Fan Palm						
16	Fan Palm						
17	Thevetia	3	\$ -				
18	Olive	*2	\$ 125				
19	Olive	*2	\$ 95				
20	Olive	*2	\$ 85				
21	Olive	*2	\$ 75				
22	Olive	*2	\$ 145				
23	Olive	*2	\$ 95				
24	Oak	*2	\$ 85				
25	Elm	2	\$ 75				
26	Olive	*2	\$ 85				
27	Gone						
28	Mesquite	1	\$ 90				
29	Mesquite	1	\$ 175				
30	Oak	3	\$ 30				
31	Olive	2	\$ 50				
32	Mesquite	1	\$ 45				
33	Mesquite	1	\$ 195				
34	Olive	2	\$ 50				
35	Olive	2	\$ 65				
36	Olive	2	\$ 35				
37	Olive	2	\$ 75				

4/1

#	Species	Priority	Trimming	Removal	Stump Grinding	Fertilize	Comments
38	Olive	2	\$ 70				
39	Olive	2	\$ 45				
40	Olive	2	\$ 95				
41	Olive	2	\$ 75				
42	Elm	2	\$ 165				
43	Mesquite	1	\$ 135				
44	Bird of Paradise	3					
45	Chinaberry	2	\$ 125				
46	Oak	2	\$ 125				
47	Elm	3	\$ 145				
48	Pistache	3	\$ -				new tree
49	Mesquite	1	\$ 260				
50	Oak	3	\$ 125				
51	Elm	1	\$ 175				
52	Mesquite	1	\$ 185				
53	Olive	2	\$ 185				
54	Olive	1	\$ 25				clean up dead tips on SE side only
55	Olive	2	\$ 125				
56	Elm	3	\$ 165				
57	Olive	2	\$ 85				
58	Olive	2	\$ 85				
59	Olive	2	\$ 75				
60	Olive	2	\$ 75				
61	Olive	2	\$ 75				
62	Olive	2	\$ 95				
63	Olive	2	\$ 125				
64	Olive	2	\$ 95				
65	Olive	2	\$ 125				
66	Olive	2	\$ 135				
67	Olive	2	\$ 145				
68	Olive	2	\$ 110				
69	Mesquite	1	\$ 195				
70	Olive	2	\$ 145				
71	Olive	2	\$ 95				
72	Thevetia	3	\$ -				
73	Olive	2	\$ 125				
74	Olive	2	\$ 115				
75	Olive	2	\$ 85				
76	Olive	2	\$ 85				
77	Olive	2	\$ 75				
78	Acacia	1	\$ 25				broken limb on east side
79	Thevetia	3	\$ -				
80	Olive	2	\$ 85				
81	Removed						
82	Pistache	3	\$ -				
83	Elm	3	\$ 65				
84	Olive	2	\$ 75				
85	Olive	2	\$ 125				
86	Olive	2	\$ 75				
87	Olive	2	\$ 125				
88	Olive	2	\$ 95				
89	Olive	2	\$ 115				
90	Olive	3	\$ 115				
91	Olive	3	\$ 125				
92	Olive	3	\$ 135				
93	Thevetia	3	\$ -				

#	Species	Priority	Trimming	Removal	Stump Grinding	Fertilize	Comments
94	Thevetia	3	\$ -				
95	Olive	3	\$ 175				
96	Thevetia	3	\$ 85				
97	Acacia	3	\$ -				
98	Thevetia	3	\$ -				
99	Oak	2	\$ 40				
100	Acacia	3	\$ -				
101	Pistache	3	\$ -				Acacia removed
102	Elm	3	\$ 165				
103	Removed						Acacia removed
104	Oak	3	\$ 50				
105	Mesquite	1	\$ 275				
106	Thevetia	3	\$ -				
107	Elm	3	\$ 20				
108	Oak	3	\$ 20				
109	Oak	3	\$ 20				
110	Removed						
111	Acacia	3	\$ 285				
112	Oak	2	\$ 75				
113	Olive	*2	\$ 125				
114	Thevetia	3	\$ -				
115	Olive	*2	\$ 115				
116	Olive	*2	\$ 145				
117	Fan Palm						short
118	Fan Palm						short
119	Olive	2	\$ 135				
120	Olive	2	\$ 95				
121	Thevetia	3	\$ -				
122	Olive	2	\$ 125				
123	Olive	2	\$ 115				
124	Olive	2	\$ 85				
125	Olive	2	\$ 85				
126	Olive	2	\$ 65				
127	Bird of Paradise	3	\$ -				
128	Olive	2	\$ 95				
129	Olive	2	\$ 95				
130	Thevetia	1		\$ 75	\$ 40		dead
131	Acacia	2	\$ 195				
132	Acacia	1	\$ 385				
133	Elm	3	\$ 65				
134	Acacia	1	\$ 195				
135	Mesquite	1	\$ 125				
136	Mesquite	1	\$ 165				
137	Mesquite	1	\$ 245				
138	Bird of Paradise	3	\$ -				
139	Olive	2	\$ 45				
140	Olive	2	\$ 60				
141	Olive	2	\$ 60				
142	Olive	2	\$ 60				
143	Olive	2	\$ 125				
144	Olive	2	\$ 85				
145	Olive	2	\$ 95				
146	Olive	2	\$ 95				
147	Olive	2	\$ 85				
148	Olive	2	\$ 75				
149	Olive	2	\$ 75				
150	Olive	2	\$ 115				

#	Species	Priority	Trimming	Removal	Stump Grinding	Fertilize	Comments
151	Olive	2	\$ 45				
152	Olive	2	\$ 55				
153	Olive	2	\$ 125				
154	Acacia	2	\$ 175				
155	Elm	3	\$ 20				
156	Mesquite	1	\$ 140				
157	Mesquite	1	\$ 295				
158	Mesquite	1	\$ 185				
159	Olive	2	\$ 35				
160	Elm	3	\$ 25				
161	Olive	2	\$ 85				
162	Olive	2	\$ 45				
163	Olive	2	\$ 60				
164	Olive	2	\$ 115				
165	Olive	2	\$ 75				
166	Olive	2	\$ 125				
167	Olive	2	\$ 95				
168	Mesquite	1	\$ 325				
169	Removed						
170	Thevetia	3	\$ -				
171	Olive	1	\$ 85				
172	Bird of Paradise	3	\$ -				
173	Olive	2	\$ 165				
174	Olive	2	\$ 75				
175	Olive	2	\$ 95				
176	Elm	3	\$ 35				
177	Olive	2	\$ 115				
178	Olive	2	\$ 60				
179	Olive	2	\$ 35				
180	Mesquite	1	\$ 195				
181	Olive	1	\$ 135				
182	Mesquite	1	\$ 185				
183	Mesquite	1	\$ 325				
184	Thevetia	3	\$ -				
185	Elm	3	\$ 50				
186	Olive	2	\$ 95				
187	Olive	2	\$ 75				
188	Olive	2	\$ 85				
189	Olive	2	\$ 115				
190	Oak	2	\$ 85				
191	Oak	2	\$ 125				
192	Oak	2	\$ 115				
193	Oak	2	\$ 115				
194	Oak	2	\$ 135				
194a	Pistache	3	\$ -				
195	Fan Palm						
196	Thevetia	3	\$ -				
197	Fan Palm						
198	Fan Palm						
199	Fan Palm						
200	Fan Palm						
201	Fan Palm						
202	Fan Palm						
203	Fan Palm						
204	Thevetia	3	\$ -				
205	Elm	3	\$ 45				
206	Elm	3	\$ 85				

#	Species	Priority	Trimming	Removal	Stump Grinding	Fertilize	Comments
207	Elm	3	\$ 115				
208	Olive	2	\$ 95				
209	Olive	2	\$ 95				
210	Olive	3	\$ -				
211	Olive	3	\$ -				
212	Olive	3	\$ -				
213	Removed						
214	Acacia	2	\$ 165				
215	Mesquite	1	\$ 130				
216	Removed						
217	Ash	1		\$ 25	\$ 30		sun scald
218	Sissoo	2	\$ 125				
219	Mesquite	1	\$ 150				
220	Bird of Paradise	3	\$ -				
221	Elm	2	\$ 35				
222	Removed						
223	Mesquite	1	\$ 365				
224	Thevetia	3	\$ -				
225	Olive	1	\$ 160				
226	Removed						
227	Olive	2	\$ 145				
228	Thevetia	3	\$ -				
229	Sissoo	2	\$ 170				
230	Sissoo	2	\$ 125				
231	Sissoo	2	\$ 110				
232	Pistache	3	\$ -				
233	Thevetia	3		\$ 15	\$ 30		dead
234	Olive	3	\$ -				
235	Olive	2	\$ 130				
236	Olive	2	\$ 120				
237	Olive	2	\$ 145				
238	Sissoo	2	\$ 85				
239	Olive	2	\$ 115				
240	Olive	2	\$ 130				
241	Olive	2	\$ 95				
242	Olive	2	\$ 145				
243	Sissoo	2	\$ 70				
244	Olive	2	\$ 75				remove low limb over sidewalk
245	Olive	2	\$ 135				
246	Mesquite	1	\$ 275				
247	Thevetia	3	\$ -				
248	Mesquite	1	\$ 130				
249	Mesquite	1	\$ 165				
250	Mesquite	1	\$ 210				
251	Mesquite	1	\$ 175				
252	Mesquite	1	\$ 175				
253	Olive	2	\$ 60				
254	Bird of Paradise	3	\$ -				
255	Bird of Paradise	3	\$ -				
256	Olive	2	\$ 125				
257	Olive	2	\$ 125				
258	Removed						
259	Bird of Paradise	3	\$ -				
260	Olive	2	\$ 95				
261	Sissoo	2	\$ 140				
262	Mulga (2)	3	\$ -				new tree
263	Olive	2	\$ 125				

#	Species	Priority	Trimming	Removal	Stump Grinding	Fertilize	Comments
264	Olive	2	\$ 125				
265	Olive	2	\$ 165				
266	Olive	2	\$ 125				
267	Bird of Paradise	3	\$ -				
268	Sissoo	3	\$ 85				
269	Bird of Paradise	3	\$ -				
269a	Mulga	3	\$ -				
270	Bird of Paradise	3	\$ -				
271	Removed						
272	Removed						
273	Sissoo	2	\$ 45				
274	Elm	3	\$ 20				new tree
275	Bird of Paradise	3	\$ -				
276	Pistache	3	\$ -				
277	Bird of Paradise	3	\$ -				
278	Mesquite	1	\$ 170				
279	Mesquite	1	\$ 420				
280	Bird of Paradise	3	\$ -				
281	Sissoo	3	\$ 35				new tree
282	Removed						
283	Acacia	1	\$ 345				
284	Sissoo	2	\$ 145				
285	Removed						
286	Thevetia	2	\$ -				
287	Sissoo	2	\$ 145				
288	Bird of Paradise	3	\$ -				
289	Bird of Paradise	3	\$ -				
290	Bird of Paradise	3	\$ -				
290a	Pistache	3	\$ -				
291	Sissoo	2	\$ 125				
292	Thevetia	3	\$ -				
293	Removed						
294	Ash	3	\$ 90				
295	Removed						
296	Acacia	1	\$ 185				
297	Ash	2	\$ 115				
298	Ash	3	\$ -				
299	Removed						
300	Removed						
301	Removed						
302	Ash	3	\$ -				new tree - paint trunk
303	Elm	3	\$ 265				
304	Oak	2	\$ 260				
305	Oak	2	\$ 145				
306	Mesquite	1	\$ 295				
307	Mesquite	1	\$ 230				
308	Mesquite	1	\$ 245				
309	Mesquite	1	\$ 265				
310	Thevetia	3	\$ -				
311	Removed						
312	Ash	1		\$ 25	\$ 35		dead
313	Removed						
314	Ash	3	\$ -				paint trunk
315	Ash	2	\$ 125				paint trunk
316	Removed						
317	Ash	2	\$ 110				
318	Stump						

#	Species	Priority	Trimming	Removal	Stump Grinding	Fertilize	Comments
319	Ash	3	\$ -				
320	Removed						
321	Removed						
322	Pistache	3	\$ -				
323	Acacia	2	\$ 145				
323	Thevetia (2)	3	\$ -				
324	Elm	3	\$ 45				
325	Elm	3	\$ 60				
326	Elm	1	\$ 175				
327	Removed						
328	Elm	1	\$ 240				
329	Thevetia	2	\$ 50				
330	Oak	1	\$ 115				
331	Elm	1	\$ 85				
332	Ash	2	\$ 125				
333	Ash	2	\$ 125				
334	Thevetia	3	\$ -				
335	Ash	3	\$ -				
336	Ash	3	\$ -				
336a	Thevetia	3	\$ -				
336b	Pistache	3	\$ -				
337	Ash	3	\$ -				major trunk damage - phase out (\$85/\$60)
337a	Thevetia (2)	3	\$ -				
338	Ash	2	\$ 35				
339	Thevetia	3	\$ -				
340	Removed						Acacia removed
341	Removed						Acacia removed
342	Removed						Acacia removed
343	Thevetia	3	\$ -				
344	Thevetia	3	\$ -				
345	Mesquite	1	\$ 450				
346	Elm	3	\$ 165				
347	Oak	2	\$ 85				
348	Oak	1	\$ 165				
349	Thevetia	3	\$ -				
350	Gone						
351	Gone						
352	Pistache	3	\$ -				
353	Thevetia	3	\$ 75				
354	Removed						
355	Removed						
356	Removed						
356a	Elm	3	\$ 25				structurally prune
357	Oak	3	\$ 35				new tree
358	Thevetia	3	\$ -				
359	Oak	2	\$ 85				
360	Oak	2	\$ 135				
361	Mesquite	1	\$ 235				
362	Elm	3	\$ 70				
363	Thevetia	3	\$ -				
364	Thevetia	3	\$ -				
365	Thevetia	3	\$ -				
366	Removed						
366a	Pistache	3	\$ -				
366b	Thevetia	3	\$ -				
367	Mesquite	1	\$ 235				

#	Species	Priority	Trimming	Removal	Stump Grinding	Fertilize	Comments
368	Mesquite	1	\$ 150				
369	Thevetia	3	\$ -				
370	Mesquite	1	\$ 450				aggressive thin/reduction
371	Removed						
372	Removed						
373	Elm	3	\$ 135				
374	Oak	3	\$ 85				
375	Oak	3	\$ 170				
376	Thevetia	3	\$ -				
377	Oak	3	\$ 170				
378	Elm	2	\$ 45				
379	Elm	2	\$ 75				
380	Elm	2	\$ 65				
381	Acacia	2	\$ 175				
382	Thevetia (6)	3	\$ -				
383	Elm	2	\$ 85				
383	Elm	3	\$ -				
384	Elm	3	\$ 140				
385	Acacia	3	\$ 260				
386	Acacia	1	\$ 70				clean up several dead tips only; check watering
386a	Mastic	3	\$ -				
386b	Pistache	3	\$ -				
387	Acacia	1	\$ 260				bucket truck
387a	Pistache	3	\$ -				
388	Pistache	3	\$ -				
389	Removed						
390	Thevetia	3	\$ -				
391	Thevetia	3	\$ -				
392	Thevetia	3	\$ -				
393	Thevetia	3	\$ -				
394	Thevetia	3	\$ -				
395	Mesquite	1	\$ 185				
396	Mesquite	1	\$ 145				
397	Thevetia	3	\$ -				
398	Ash	3	\$ -				paint trunk
399	Pistache	3	\$ -				paint trunk
400	Ash	3	\$ -				paint trunk
401	Ash	3	\$ 20				paint trunk
402	Thevetia	3	\$ -				
402a	Pistache	3	\$ -				
403	Elm	3	\$ 30				new tree
404	Mesquite	1	\$ 340				
405	Removed						
406	Removed						
407	Mesquite	1	\$ 245				
408	Bird of Paradise	3	\$ -				
409	Ash	3	\$ -				
410	Acacia	1	\$ 285				
411	Bird of Paradise	3	\$ -				
411a	Pistache	3	\$ -				
412	Oak	1	\$ 145				
413	Bird of Paradise	3	\$ -				
414	Thevetia	3	\$ -				
415	Removed						
416	Oak	1	\$ 25				2 broken limbs
417	Removed						

#	Species	Priority	Trimming	Removal	Stump Grinding	Fertilize	Comments
418	Removed						
419	Elm	3	\$ 35				
420	Elm	3	\$ 35				
421	Stump	1			\$ -		we forgot stump (\$50 N/C)
422	Thevetia	2	\$ 60				
423	Elm	3	\$ 115				
424	Elm	2	\$ 65				
425	Mesquite	1	\$ 225				
426	Thevetia	3	\$ -				
427	Oak	2	\$ 210				
428	Thevetia	3	\$ -				
429	Bird of Paradise	3	\$ -				
430	Thevetia	3	\$ -				
431	Removed						Mesquite removed
432	Oak	2	\$ 135				
433	Oak	2	\$ 165				
434	Thevetia	3	\$ -				
435	Oak	2	\$ 230				
436	Thevetia	3	\$ -				
437	Thevetia	3	\$ -				
438	Thevetia	3	\$ -				
439	Oak	3	\$ 165				
440	Thevetia	3	\$ -				
441	Mesquite	1	\$ 165				
442	Mesquite	1	\$ 185				
443	Thevetia	3	\$ -				
444	Removed						Acacia removed 2017
445	Thevetia	3	\$ -				
446	Mesquite	1	\$ 195				
447	Mesquite	1	\$ 330				
448	Oak	2	\$ 165				
449	Thevetia	3	\$ 195				
450	Elm	3	\$ 115				
451	Elm	3	\$ 365				
452	Mesquite	1	\$ 385				aggressive thin/reduction
453	Thevetia	3	\$ -				
454	Bird of Paradise	3	\$ -				
455	Mesquite	1	\$ 285				
456	Mesquite	1	\$ 185				
457	Mesquite	1	\$ 45				
458	Mesquite	1	\$ 195				
459	Thevetia	3	\$ -				
460	Removed						
461	Acacia	2	\$ 150				
462	Mesquite	1	\$ 165				
463	Mesquite	1	\$ 165				
464	Removed						
465	Thevetia	3	\$ -				
466	Elm	3	\$ 90				
467	Mesquite	1	\$ 115				
468	Elm	2	\$ 45				
469	Elm	2	\$ 70				
470	Acacia	1	\$ 375				
471	Acacia	2	\$ 240				
472	Acacia	2	\$ 230				
473	Elm	1	\$ 185				
474	Mesquite	1	\$ 275				

#	Species	Priority	Trimming	Removal	Stump Grinding	Fertilize	Comments
475	Mesquite	1	\$ 150				
476	Mesquite	1	\$ 40				
477	Mesquite	1	\$ 115				
478	Removed						
479	Thevetia	3	\$ -				
480	Mesquite	1	\$ 195				
481	Elm	2	\$ 45				
482	Elm	2	\$ 65				
483	Elm	2	\$ 165				
484	Elm	3	\$ 115				
485	Elm	1	\$ 160				
486	Mesquite	1	\$ 35				
487	Oak	3	\$ 170				
488	Thevetia	3	\$ -				please give input on how you want to address overgrown thevetia trees - would you like us to prune them? Or have them cut down in height?
489	Oak	3	\$ -				
490	Elm	3	\$ -				
491	Thevetia	3	\$ -				
492	Mesquite	1	\$ 330				note to crew: make sure to reduce well from property
493	Elm	3	\$ 35				
494	Mesquite	1	\$ 130				
495	Thevetia	3	\$ -				
495a	Pistache	3	\$ -				
496	Mesquite	1	\$ 165				
497	Oak	3	\$ 30				
498	Oak	3	\$ 45				
499	Mesquite	1	\$ 145				
500	Removed						Mesquite removed
501	Mesquite	1	\$ 115				
502	Oak	2	\$ 85				
502a	Pistache	3	\$ -				
503	Pistache	3	\$ -				
504	Pistache	3	\$ -				
505	Oak	2	\$ 90				
506	Oak	2	\$ 145				
507	Elm	2	\$ 95				
508	Elm	2	\$ 45				
509	Acacia	2	\$ 350				
510	Thevetia	3	\$ -				
511	Elm	2	\$ 95				
512	Elm	2	\$ 85				
513	Oak	3	\$ 35				major trunk damage
514	Elm	2	\$ 95				
515	Mesquite	1		\$ 150	\$ 45		dead
516	Elm	1	\$ 90				
517	Oak	3	\$ 35				
518	Removed						
519	Oak	3	\$ -				
520	Oak	3	\$ -				
520a	Pistache	3	\$ -				
520b	Pistache	3	\$ -				
520c	Pistache	3	\$ -				
521	Oak	3	\$ -				

#	Species	Priority	Trimming	Removal	Stump Grinding	Fertilize	Comments
521a	Pistache	3	\$ -				
522	Removed						
523	Mesquite	1	\$ 165				
524	Elm	3	\$ 185				
525	Mesquite	1	\$ 220				
525a	Pistache	3	\$ -				
525b	Pistache	3	\$ -				
526	Gone						
527	Thevetia	3	\$ -				
528	Mesquite	1	\$ 195				
529	Pistache	3	\$ -				
530	Bird of Paradise	3	\$ -				
530a	Pistache	3	\$ -				
531	Mesquite	1	\$ 145				
532	Pistache	3	\$ -				
533	Thevetia	3	\$ -				
534	Acacia	2	\$ 350				
535	Thevetia	3	\$ -				
536	Ash	3	\$ -				
537	Thevetia	3	\$ -				

NOTE: See estimate for grand total pricing including taxes (for removals or stump grinding) and environmental fees.

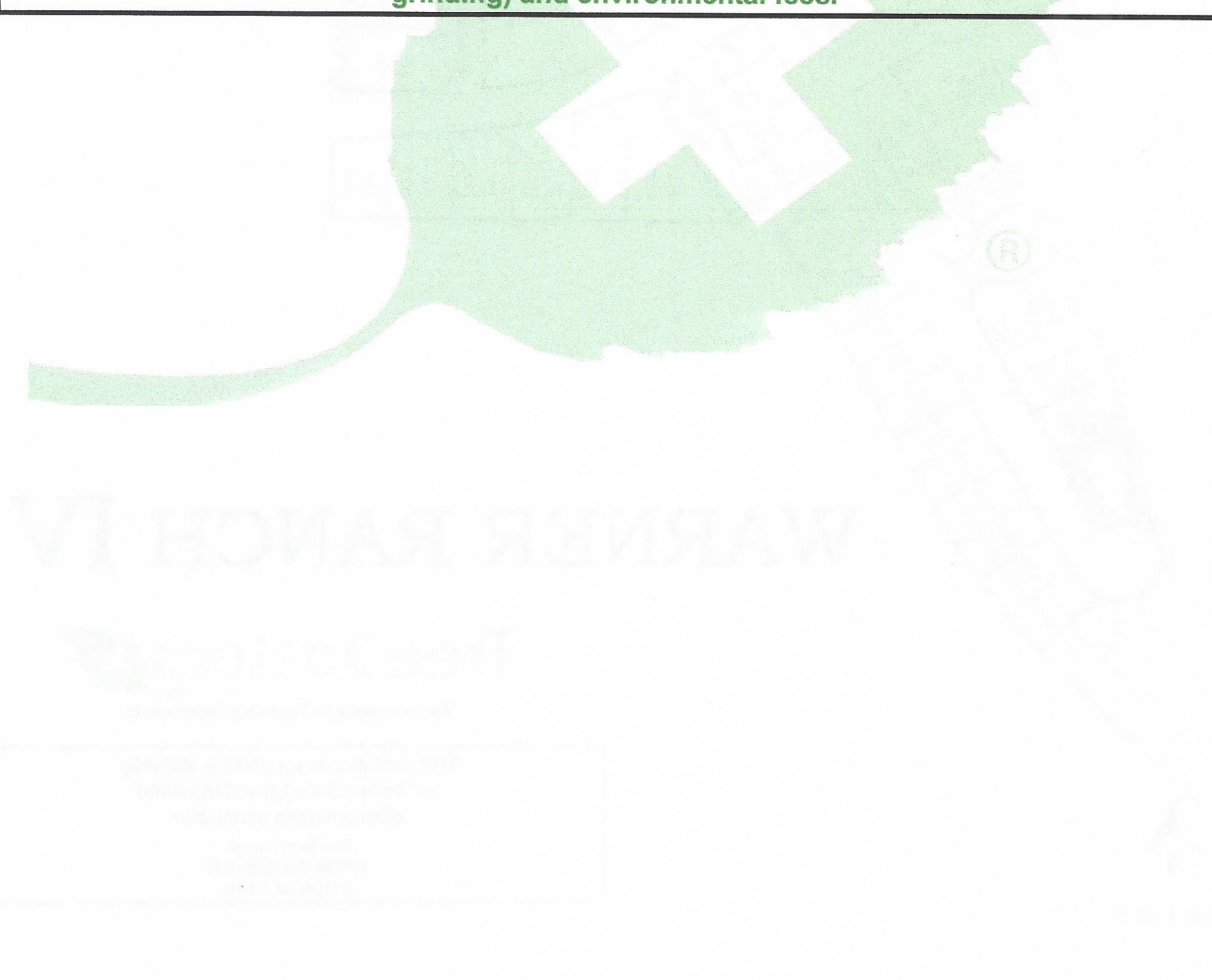

WARNER RANCH IV

Warner Ranch IV

Warner Ranch IV

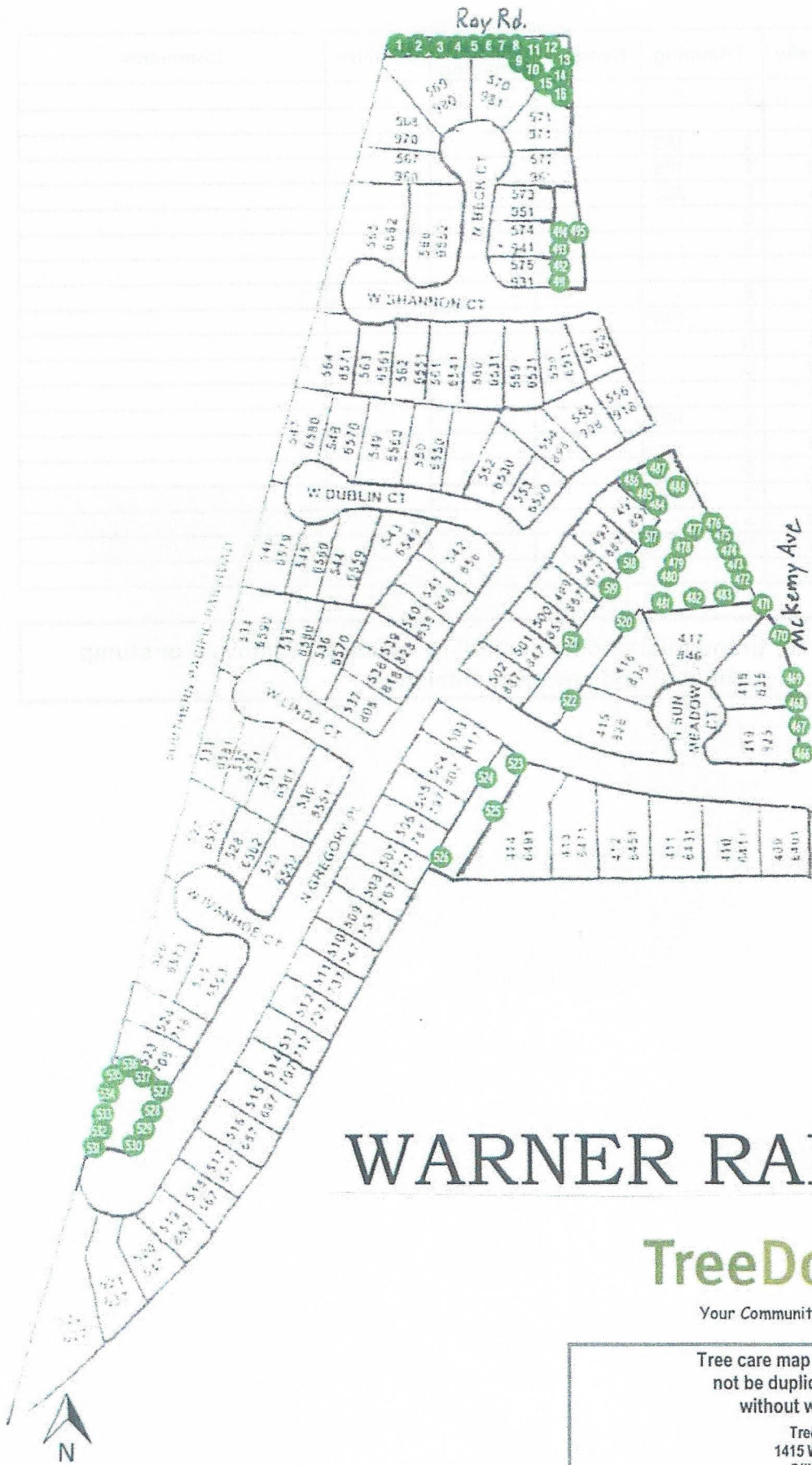

WARNER RANCH IV

TreeDoctors

Your Community Tree Care Specialists

Tree care map is proprietary and may not be duplicated or redistributed without written permission

Tree Doctors, Inc.
1415 W. San Angelo St
Gilbert, AZ 85233



WARNER RANCH IV

TreeDoctors 

Your Community Tree Care Specialists

Tree care map is proprietary and may not be duplicated or redistributed without written permission

Tree Doctors, Inc.
1415 W. San Angelo St
Gilbert, AZ 85233



Ray Rd.

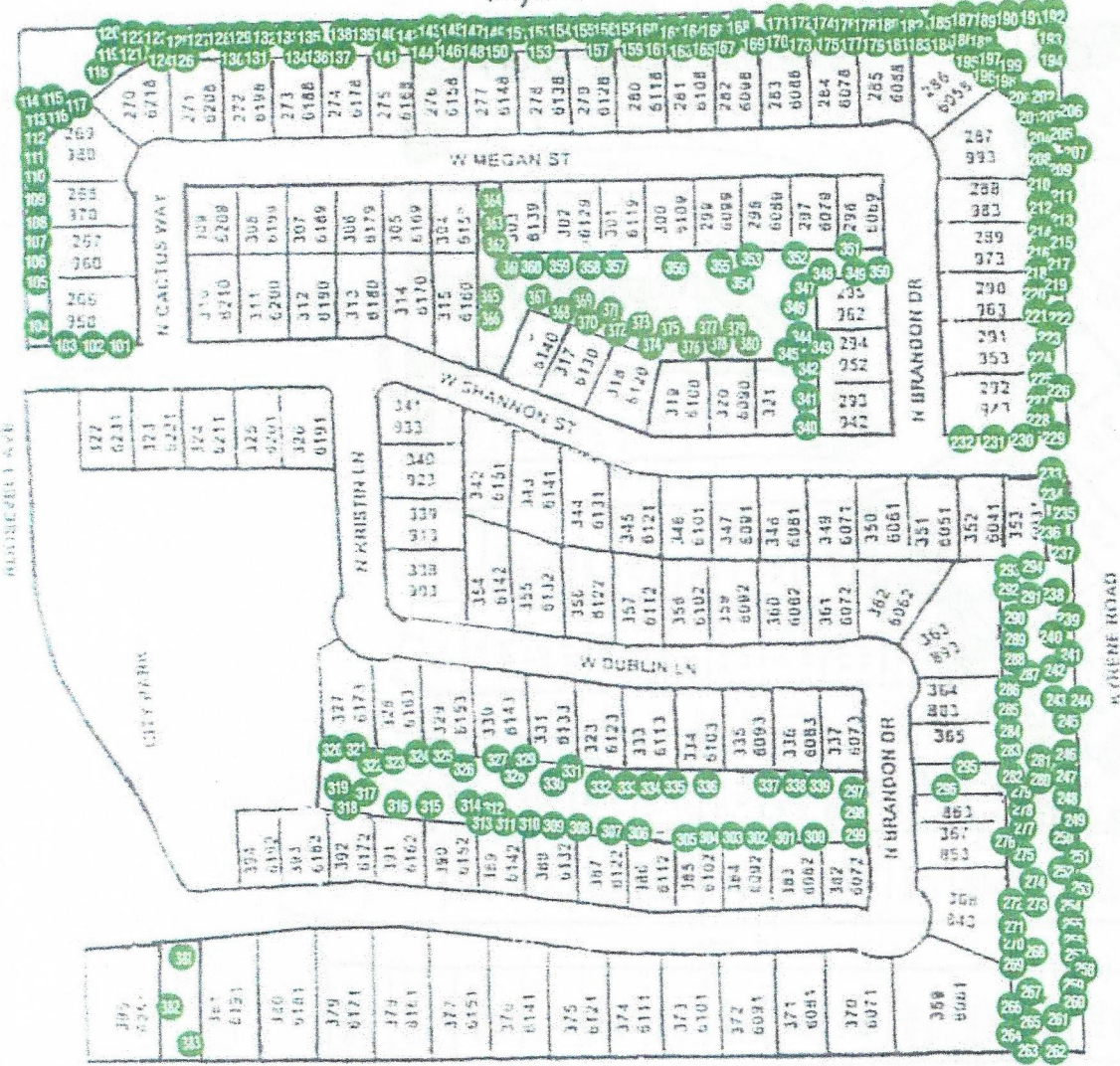

WARNER RANCH IV

TreeDoctors

Your Community Tree Care Specialists

Tree care map is proprietary and may not be duplicated or redistributed without written permission

Tree Doctors, Inc.
1415 W. San Angelo St
Gilbert, AZ 85233

